



ZIFF
REAL ESTATE
PARTNERS

BRIDGEPORT I

210 Wingo Way
Mt. Pleasant, SC 29464

LEASING CONTACT

Drayton Calmes
843.579.0053
draytonc@norvellgroup.com

ZIFF REAL ESTATE PARTNERS
210 Wingo Way, Suite 400
Mount Pleasant, SC 29464

PROPERTY HIGHLIGHTS

Bridgeport I is a three-story multi-tenant office building that was constructed in 2004. It is ideally situated just before the Ravenel Bridge to downtown Charleston, making it one of Mount Pleasant's most central and convenient locations. This office building is close to shopping, restaurants, grocery stores and banking. You will be minutes away from Shem Creek, Towne Centre and Patriots Point.

Demographics	3 Mile	5 Mile	10 Mile
Population	16,674	68,353	189,290
Projected	17,965	77,423	206,138
Avg. HH Income	\$136,050	\$107,074	\$107,836
Med. HH Income	\$89,609	\$71,511	\$74,510



GLA: 30,792 SF



49,700 + VPD



Near Hwy 17 & 526

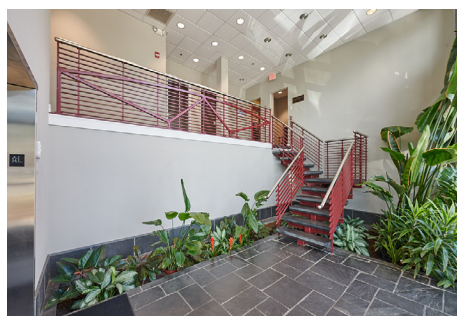

WWW.ZIFFCRE.COM



ZIFF
REAL ESTATE
PARTNERS

BRIDGEPORT I

210 Wingo Way
Mt. Pleasant, SC 29464

LEASING CONTACT

Drayton Calmes
843.579.0053
draytonc@norvellgroup.com

Notice of disclaimer: All square footages and dimensions are approximate and subject to field verification.

Available Space

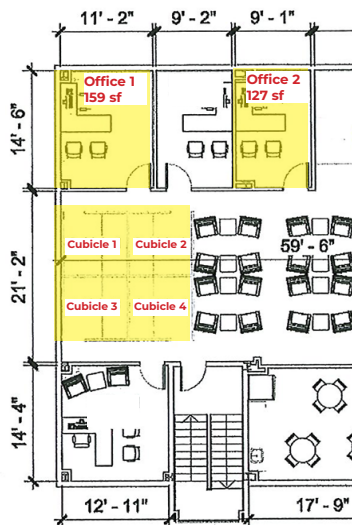

Available space includes 2 executive suites and 4 cubicles on the fourth floor. Brand new office with kitchen and gathering area, conference room, bathrooms with shower and free on-site parking. Utilities included with gross lease.

Overall Floor Plan

